

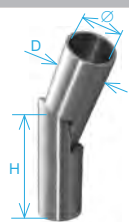

flush angles adjustable

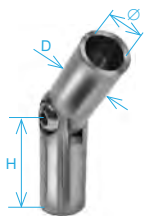

Quality	Finish	∅	art.	H	D
AISI304	satin	12	A/0302-012-S	30	13,5



Quality	Finish	∅	art.	H	D
AISI304	satin	10	A/0302-010	36	14
		12	A/0302-012	36	16
		14	A/0302-014	37	18
AISI316	polish	12	A/0302-012-L	36	16
		12	A14/0302-012	36	16

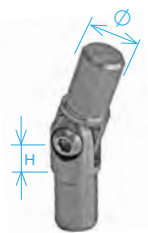

Quality	Finish	∅	art.	H
AISI304	satin	16x1,5	A/0302-016	12

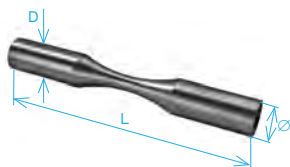

Quality	Finish	∅	art.	L	D
AISI304	satin	12	A/0012-012	102	14

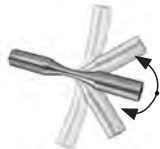

flush angles, connectors



Quality	Finish	∅	art.	H
AISI304	satin	12x1,0	A/0305-112	9
		12x1,5	A/0305-012	9



Quality	Finish	∅	art.	D
AISI304	satin	12	A/0220-225	25

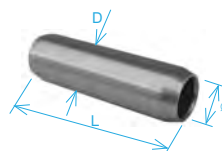

Quality	Finish	∅	art.	L	D
AISI304	satin	10	A/0040-010	40	12
		12	A/0040-012	40	14
		14	A/0040-014	40	16
		16	A/0040-016	40	18
		12	A/0040-012-L	40	14



Quality	Finish	∅	art.	h	D	d
AISI304	satin	12x1,5	A/0041-012	2	12	9



2D

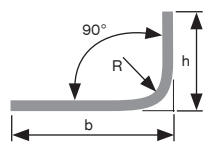

art.	b x h	R
OHYB/2D-A12-90	?	50

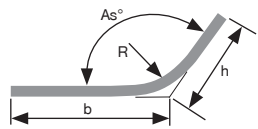

art.	b x h x As	R
OHYB/2D-A12-As	?	50

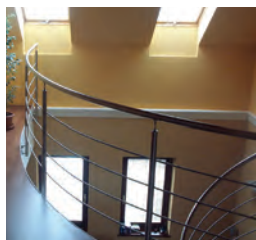

art.	d
Q8/17	3/8", 1/2", 9/16", 5/8", 3/4", 7/8"

connectors



Quality	Finish	∅	art.	b
AISI304	satin	33,7x2,0	A/0790-233	6
		42,4x2,0	A/0790-242	5
		48,3x2,0	A/0790-248	5
AISI316	polish	42,4x2,0	A/0790-242-L	5
		42,4x2,0	A14/0790-242	5

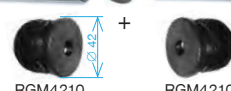
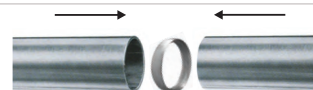
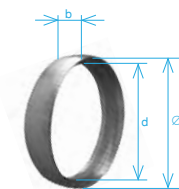

Quality	Finish	∅	art.	b	d
AISI304	satin	42	A7/42-11-A	10	39

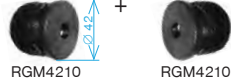
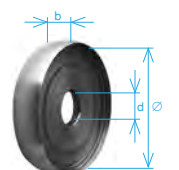

Quality	Finish	∅	art.	b	d
AISI304	satin	42	A7/42-11	10	11

