

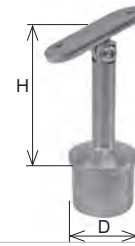

Quality	Finish	∅	art.	H	D
AISI304	satin	33,7	A/0717-233	79	33,7x2,0
		42,4	A/0718-242	81	42,4x2,0
		48,3	A/0718-248	79	42,4x2,0
		48,3	A/0719-248	80	48,3x2,0
AISI316	polish	42,4	A/0718-242-L	79	42,4x2,0
		42,4	A14/0718-242	79	42,4x2,0
AISI316	satin	42,4	A14/0718-242	79	42,4x2,0
		42,4	A14/0718-242-L	79	42,4x2,0

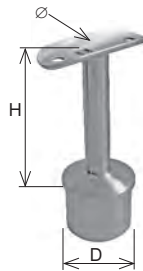

Quality	Finish	art.	H	D
AISI304	satin	A/0717-200	79	33,7x2,0
		A/0718-200	81	42,4x2,0
		A/0718-200-B	78,5	42,4x1,5
		A/0719-200	80	48,3x2,0
AISI316		A14/0718-200	79	42,4x2,0



Quality	Finish	∅	art.	H	D
AISI304	satin	33,7	A/0710-233		
	satin	42,4	A/0710-242	78,5	42,4x2,0
AISI316	satin	42,4	A14/0710-242	78,5	42,4x2,0

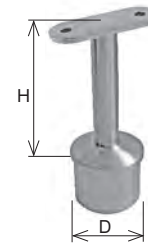

Quality	Finish	art.	H	D
AISI304	satin	A/0710-200	79	42,4x2,0



Quality	Finish	∅	art.	H	D
AISI304	satin	33,7	A/0709-833	79	33,7x2,0
		42,4	A/0710-842	80	42,4x2,0
		48,3	A/0711-848	79	48,3x2,0
AISI316	polish	42,4	A/0710-842-L	78,5	42,4x2,0
		42,4	A14/0710-842	79	42,4x2,0

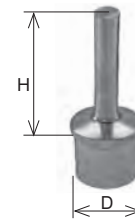

Quality	Finish	art.	H	D
AISI304	satin	A/0700-042	76	42,4x2,0



Quality	Finish	∅	art.	H	D
AISI304	satin	42,4	A/0716-242	57	42,4x2,0



Quality	Finish	art.	H	D
AISI304	satin	A/0716-000	57	42,4x2,0

